

VL2500™ Wash

l u m i n a i r e



The VARI***LITE**® VL2500™ Wash luminaire is based on one of our most popular luminaires – the VL2000™ Wash – with some new changes that make it more desirable than ever.

The VL2500 Wash luminaire is equipped with the same features and characteristics that make the original Series 2000™ fixtures so useful. It is still small, lightweight, and fast with a 700-watt short-arc lamp, impressive lumen output, and a zoom range from 14° to 55°. Of course, the VL2500 Wash luminaire still provides three-wheel CYM color mixing. When combined with 11 standard colors on a fixed wheel, the color options are practically limitless.

The new features in this luminaire are the coated glass dimmer wheel which provides smooth fades, and a separate dual-blade strobe system that offers quiet and reliable strobe effects. In addition, the VL2500 Wash luminaire's pan and tilt motors are now more powerful and provide more torque.

The fixture is the same size as the VL2500™ Spot luminaire, and it has the same profile, providing a consistent hang configuration and appearance no matter which luminaire type is required.

The VL2500 Wash luminaire can be controlled from virtually any DMX512 console or DMX output device.

Programmable Functions

Color System:	A three-filter CYM cross-fading mechanism. A fixed color wheel with 11 interchangeable color filters and one open space capable of continuous rotation for additional effects
Zoom Optics:	Continuously variable field angle from 14° to 55.5°.
Beam Size Control:	A zoomable beam spreader mechanism provides continuous beam size control for both rapid changes and smooth timed beam angle adjustments.
Intensity Control:	A coated glass dimmer wheel provides full field dimming designed for smooth timed fades.
Strobe:	A high-performance dual blade strobe system capable of ultra-fast operation.
Pan & Tilt:	Smooth, timed continuous motion by way of a three-phase stepper motor system.
Range:	Pan - 540°, Tilt - 270°.
Accuracy:	0.3° resolution.

Description

Source:	700 Watt Short Arc Lamp	Color Temperature	5600°K
		CRI	80
Output:	14,700 lumens.		
Power Requirements:	Standard AC power distribution from 90-264 VAC, 50/60 Hz. The unit requires 4 to 12 A depending on the AC supply voltage.		
Reflector:	Precision glass reflector with dichroic cold mirror coating.		
Operational Temperature:	-20° to 122°F (-29° to 50°C). Note: Derate to 113°F (45°C) for operation below 100 VAC		
Cooling:	Forced air cooling.		
Control:	Completely compatible with a wide variety of DMX512 consoles.		
DMX Channels:	15		
Mounting Position:	The VL2500™ Wash luminaire can be mounted and operated in any orientation.		
Spacing:	Hangs on 19.0 in. (48.3 cm) centers.		
Weight:	57.3 lbs (26.1 kg)		

Accessories

71.2528.0700	700 Watt Short Arc Lamp
22.9620.0194	Safety Cable Assembly
55.6840.0001	Truss Hook, Mega-Clamp (Round and Square)
55.6841.0001	Truss Hook, Mega-Claw for 2" Round Tube
41.6006.0390	3200K Color Correction filter

PART # : 20.9676.0002



VARI***LITE**®
Express yourself.

Vari-Lite is a Philips group brand

PHILIPS

VL2500™ Wash

l u m i n a i r e

Specifications

The unit is an integrally designed, remote-controlled, motorized wash luminaire. The head, yoke and enclosure housings are constructed of aluminum alloy, plastic and steel for lightweight strength and durability. Virtually silent fans provide forced-air cooling for internal components. The rear cap is removable, providing easy access to the lamp for replacement.

A single AC input cable along with two five-pin DMX512 compatible connectors (in and through) are provided. The unit can be controlled by a wide variety of DMX512 consoles. In addition, a built-in Master/Slave function enables operation of multiple luminaires without a control console.

Each unit is equipped with multiple on-board processors providing diagnostic and self-calibration functions as well as internal test routines and software update capabilities.

The unit contains two independent three-phase stepper motors to provide movement of the head through 540° in the horizontal plane (pan) and 270° in the vertical plane (tilt). The pan and tilt mechanisms are belt-driven, providing positional resolution and repeatability of 0.3° on either axis.

A CYM color mixing system using three color wheels is provided for a broad range of user color selection. The color system is capable of color changes in less than 0.6 seconds. In addition to the CYM system, a fixed color wheel with 11 discrete colors is included for specific color requirements and snap color changes in .14 seconds.

The unit contains a coated glass dimmer wheel that provides full field dimming and allows for both smooth timed fades and fast blackouts. A high-performance, dual blade strobe system is operated with two motors and is capable of various strobe effects. The unit is equipped with a zoomable beam spreader that allows continuous field angle changes from 14° to 55.5° in less than 1.8 seconds.

The unit is ETL and ETLc certified and CE-marked. Exterior finish is black.

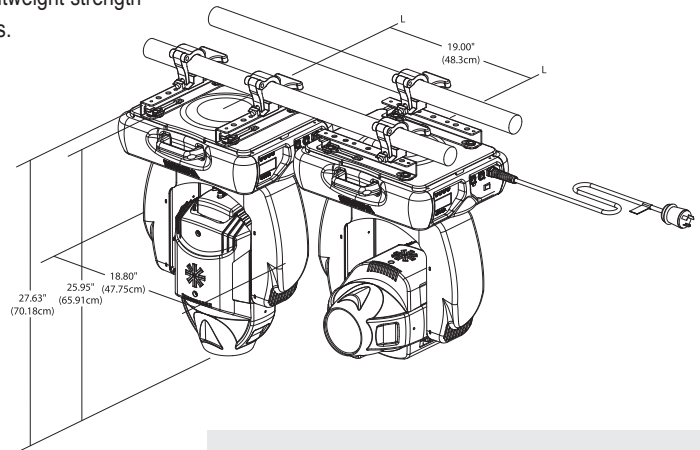

Photometric Data*



VL2500 Wash Luminaire - 700W Metal Halide					
Lens	Candela* (cd)	Beam Angle (DEGREES)	Beam Diameter TN ¹	Field Angle (DEGREES)	Field Diameter TN ¹
No lens travel	580,000	8°	.14	14°	.248
1/4 lens travel	295,000	11°	.192	21°	.369
1/2 lens travel	119,000	17°	.304	33°	.596
3/4 lens travel	56,500	27.5°	.491	45°	.831
Full lens travel	33,000	35.8°	.646	55.5°	1.054

¹ Multiply distance by Tn to determine coverage.

To calculate center beam Illuminance (I), at a specific distance (D): $I = \frac{cd}{D^2}$
 — if (D) is in feet, (I) is in foot candles
 — if (D) is in meters, (I) is in lux

* Note:
 All data taken with seasoned light source at 20 hours of life.
 All data taken with front stipple glass in place.
 Fixture output = 14,700 lumens.

VARI*LITE®
 Express yourself.

©2008 Philips Group. All rights reserved. Printed in the U.S.A. VARI*LITE® is a trademark owned by Philips Group and is registered in the United States and other countries. VL2500™ and the Vari-Lite Asterisk are also trademarks owned by Philips Group. Certain products listed in this document may be protected by applicable patents and patents pending. Philips will aggressively defend all of its intellectual property. We reserve the right to change details of design, materials and finishes. Specifications are subject to change without notice. VARI*LITE® automated lighting equipment is made in the U.S.A.

Vari-Lite
 10911 Petal Street
 Dallas, TX 75238
 1.877.VARILITE
 fax: 214.647.8038
 www.vari-lite.com



VL2500W_0808